

Built by Strategic Marine in Singapore and due for delivery in January 2023, the Valiant is a BMT designed 27m aluminium catamaran; the design maximises deck space and cargo carrying capacity.



# Valiant

27-METRE MULTI-PURPOSE WIND FARM SERVICE VESSEL

# Valiant

27-METRE WIND FARM SERVICE VESSEL

The vessel engine and propulsion design for the 'Valiant' is such that it can be made Hybrid compliant if a client requests it.

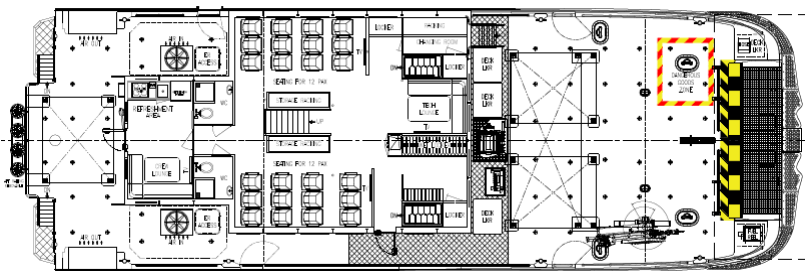
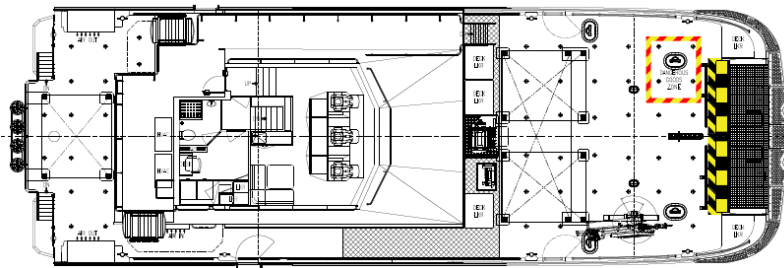
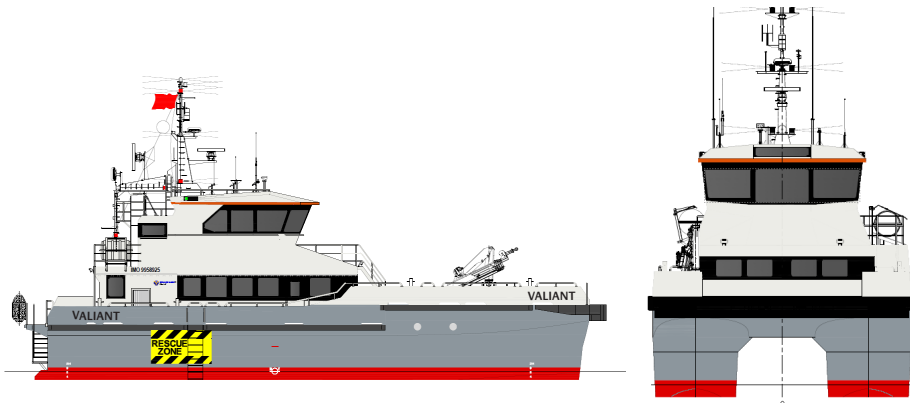

## GENERAL SPECIFICATION

Length overall	27.5 metres
Beam	8.9 metres
Min. draft	1.3 metres
Max. draft	1.66 metres
Material	Aluminium
Aft deck space	29.3 m <sup>2</sup>
Fwd deck space	52.4 m <sup>2</sup>
Maximum speed	26 knots
Fuel capacity	35,000 lts
Range	1600 nm
Cargo capacity	39 tonnes

## MACHINERY

Main engines	2x Caterpillar C32 1463hp
Propulsion	2 x FPP (1.2m DIA)
Generator	2 x Kohler 35kW
Deck crane	Palfinger PK 12000 Marine Crane
A-frame	Available on request
Survey tables	Available on request

## CLASSIFICATION

Class notation	CR100 Crew Boat, Greater Coastal Service
Flag/Coding	R.O.C
Personnel	24 + 3

manorrenewableenergy

### ABOUT MRE

Vessel provision, temporary power and engineering solutions for the offshore industry.

[www.mreltd.co.uk](http://www.mreltd.co.uk)

### OFFICE LOCATION

Manor Renewable Energy Ltd, 4F., No. 87, Sec. 1, Nanchang Rd., Zhongzheng Dist., Taipei City 100, Taiwan

### CONTACT

T: 01305 820777

T: 02392 984819

E: [info@mreltd.co.uk](mailto:info@mreltd.co.uk)

