

Built by Strategic Marine in Singapore and delivered in Summer 2022, the Victor and Vulcan are BMT designed 27m aluminium catamarans; the design maximises deck space and cargo carrying capacity.



Manor Victor / Vulcan

27-METRE MULTI-PURPOSE WIND FARM SERVICE VESSELS

Manor Victor / Vulcan

27-METRE WIND FARM SERVICE VESSELS

The vessel engine and propulsion design for the 'Manor Victor' and 'Manor Vulcan' is such that they can be made Hybrid compliant if a client requests it.

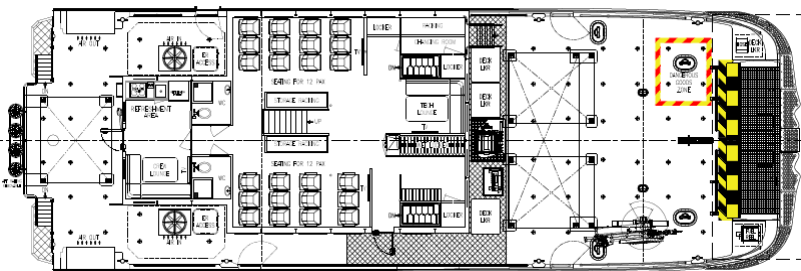
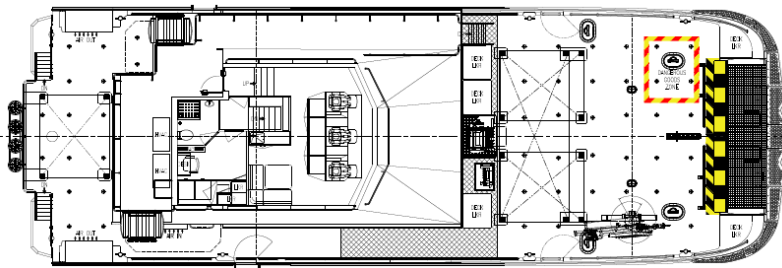
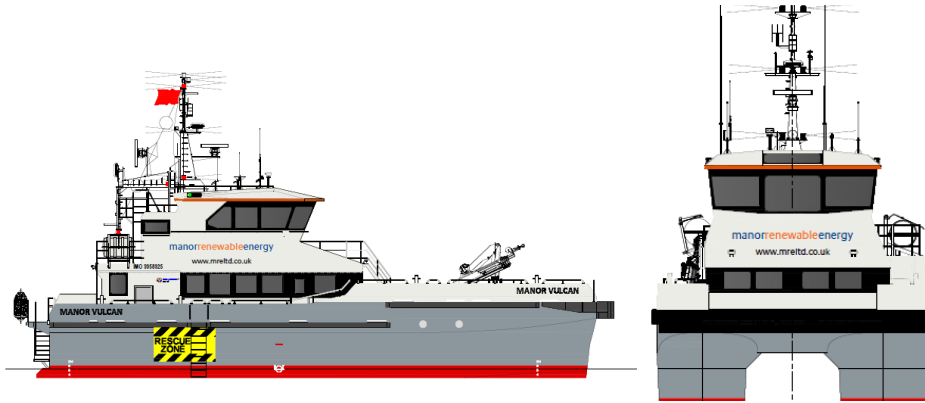

GENERAL SPECIFICATION

| | |
|----------------|---------------------|
| Length overall | 27.5 metres |
| Beam | 8.9 metres |
| Min. draft | 1.3 metres |
| Max. draft | 1.66 metres |
| Material | Aluminium |
| Aft deck space | 29.3 m ² |
| Fwd deck space | 52.4 m ² |
| Maximum speed | 26 knots |
| Fuel capacity | 35,000 lts |
| Range | 1600 nm |
| Cargo capacity | 39 tonnes |

MACHINERY

| | |
|---------------|---------------------------------|
| Main engines | 2x Caterpillar C32 1463hp |
| Propulsion | 2 x FPP (1.2m DIA) |
| Generator | 2 x Cat C4.4 38ekW |
| Deck crane | Palfinger PK 12000 Marine Crane |
| A-frame | Available on request |
| Survey tables | Available on request |

CLASSIFICATION

| | |
|----------------|-----------------------------|
| Class notation | BV Windfarm Service Ship S0 |
| Flag/Coding | UK Cat 1 HS-OSC inc. DG |
| Personnel | 24 + 3 crew |

manorrenewableenergy

ABOUT MRE

Vessel provision, temporary power and engineering solutions for the offshore industry.

www.mreltd.co.uk

OFFICE LOCATIONS

Portland
Portsmouth
Glasgow
Taipei

CONTACT

T: 01305 820777

T: 02392 984819

E: info@mreltd.co.uk

